

## MOBILE BOTANICAL GARDENS

Prior to European settlement in the 1700's, the land on which Mobile Botanical Gardens stands today was part of a vast longleaf pine forest. Because most of this land was logged for longleaf pine in the early 1900's, the forest that you can visit today in our 35 acre conservation area (to the east of the parking lot) is actually considered second generation growth. The lake you drove in by once served as Mobile's early water source until the 1950's, which is why the acreage surrounding the lake was restricted from development. In all, the Mobile Botanical Gardens consists of 100 acres of special gardens and Longleaf conservation area. We hope you enjoy your visit to the Gardens today and encourage you to go to our website [www.mobilebotanicalgardens.org](http://www.mobilebotanicalgardens.org) or stop in at the office for additional information. MBG is a private, non-profit organization, and we appreciate your support!

### 2. *The ReBloom Garden* STOPS 4, 5, 10

The ReBloom Mobile project sought to rekindle the spirit of community gardening in the City of Mobile and to provide suggestions for plants to achieve a 12-month color display. In conjunction with the ReBloom Garden, an online ReBloom catalog offers access to outstanding plant selections for local gardens that are not commonly available. Look for the ReBloom QR codes throughout the Gardens for plants that we offer for sale or visit our catalog website at [mbgrebloomshop.com](http://mbgrebloomshop.com)

### 3- *Millie McConnell Rhododendron Garden* STOPS 6-9 and 11-14

The Millie McConnell Rhododendron Garden began as a native azalea garden, planted by Tom Dodd, John Allen Smith, and Dr. John Gojordano. The garden was redesigned in 2006 to showcase azalea hybrids either created in Mobile, or especially well suited to our climate. These groups include the Eugene Aromi, Tom Dodd, and Kosaku Sawada hybrids. This Garden also boasts the largest public collection of Satsuki azaleas in the U.S., as well as an extensive collection of historic Southern Indica azaleas. Mobile, a port city dating back to the mid 1700's, featured intricate ironwork on many commercial and residential structures. These plants are set among 19th century architectural artifacts. The central gathering area within the Rhododendron Garden is surrounded by reclaimed 10-foot cast iron columns from 19th century architecture. The pavers in the circle area were handmade and at one time were sited downtown in the de Tonti Square near Beauregard Street.

### 4- *Founders Fragrance and Texture* STOP 18

This garden is often called the Founders Garden because it was designed, planted and maintained by the founders of the Mobile Botanical Gardens in the early 1970's. It was designed as a trail for the handicapped, especially those who are visually impaired or with mobility issues. In July of 2015, this garden was completely destroyed by fire. We continue to rebuild this feature of the Gardens and incorporate more elements of fragrance and texture throughout.

### 5- *The John Allen Smith Japanese Maple Garden* STOP 19

The specimen trees in this garden were relocated here from Mr. Smith's private collection. This serene garden serves as the site for memorials and dedication plaques recognizing many significant contributors to MBG.

### 6- *The Sybil Burnett Herb Garden* STOP 20

The raised beds you will find here will introduce you to herbs classified as culinary, spiritual, medicinal, native, historical, household, and fragrant. Around the perimeter of the Herb Garden

you will find gingers, montbretia, Lady Banks climbing roses, a Turkey Fig tree, and a beautiful calamondin tree. The care of this garden is performed by members of the Gulf Coast Herb Society.

### 7- *Piff Plaza and Fountain* STOP 2

The courtyard features clumping bamboo, shrubs, annuals and perennials such as farfugium. This garden changes with the seasons, but always features something interesting. The Piff Fountain, located in the center of the plaza, was donated in memory of Mrs. Elsa Piff – a long-time supporter of the Gardens. Her beautiful Plumeria are on display here every spring and summer.

### 8. *Pollinator Garden*

This garden serves as a major attraction for the pollinators as they migrate through our area. In 2014 the Bruce Larsen butterfly sculpture, Transformation, was given on a long term loan to the Gardens from the Mobile Museum of Art. This sculpture serves as the focal point of the Butterfly and Pollinator Garden.

### 11. *Kosaku Sawada Winter Garden* STOPS 22 - 25

This garden is named in honor of Kosaku Sawada who immigrated from Japan in the early 1900's and settled in Mobile. Sawada hybridized many camellias which are now famous around the world. The Winter Garden began with plantings by Tom Sawada and in 2007, under the direction of Bobby Green, this garden was re-established with a polished design and the addition of more camellia specimens. This collection has been named a Garden of Excellence as determined by the International Camellia Society. Currently there are only 23 recognized collections in the world. The Dodd Quarry at the south end of Winter Garden was dedicated in 2010 to honor local plantsman, William Dodd. Reclaimed materials from old Mobile were used here to create this unique feature. The large, granite slabs as well as pavers and cobblestones were once part of an old graveyard in downtown Mobile. The massive decorative iron columns date to mid-1800's and once adorned the façade of a commercial structure long since destroyed.

### 13. *The Tea Maze* STOP 29

Still a work in progress, the shape of tea maze is inspired by a Chinese medallion from the Ming Dynasty. These plants were grown from cuttings of the plants from the old Lipton Tea plantation in Baldwin County. Did you know that tea is made from the leaves of the camellia sinensis? As tea became more popular in the West, many requests went to China for tea plants. Misinterpreting the requests (perhaps intentionally) the Chinese sent flowering camellia japonicas instead, introducing these beautiful plants to Europe and the Americas.

### 17. *The Katherine Shropshire Nature Trail*

Dedicated in 1981 and reopened in 2014, this trail is a ¼ mile walk through a wooded area. The careful observer may be treated with many different forms of wildlife as well as a wide variety of plants and trees native to our area.

### 18. *Aromi Hybrid Azalea Garden*

This garden houses the most significant collection of Aromi Hybrid Azaleas in the country. Dr. Eugene Aromi created these azaleas to specifically suit the unique conditions found in Mobile and the Gulf Coast. His hybrids azaleas combine the hardiness and fragrance of native deciduous azaleas with the large flower trusses and color of the cold weather suited Exbury hybrids.

# Mobile Botanical Gardens



## Welcome to the Gardens!

Wednesday - Sunday: 9am -4pm with  
last admission at 3pm

hours may differ during Summer months

CLOSED: Monday and Tuesday

Admission: Adults \$5

Children 12 and under Free

please pay at the office located near the Butterfly sculpture



Mobile Botanical Gardens is not a public park. It is a private, non-profit organization. Less than 2% of our funding comes from government sources, including the City of Mobile. Please help us continue our mission of education and protecting the collections by paying admission or becoming a member.



Check our website for seasonal hours and current events



251•342•0555

[www.mobilebotanicalgardens.org](http://www.mobilebotanicalgardens.org)  
5151 Museum Drive - Mobile, AL 36608

➤ Become a Member!



# Mobile Botanical Gardens

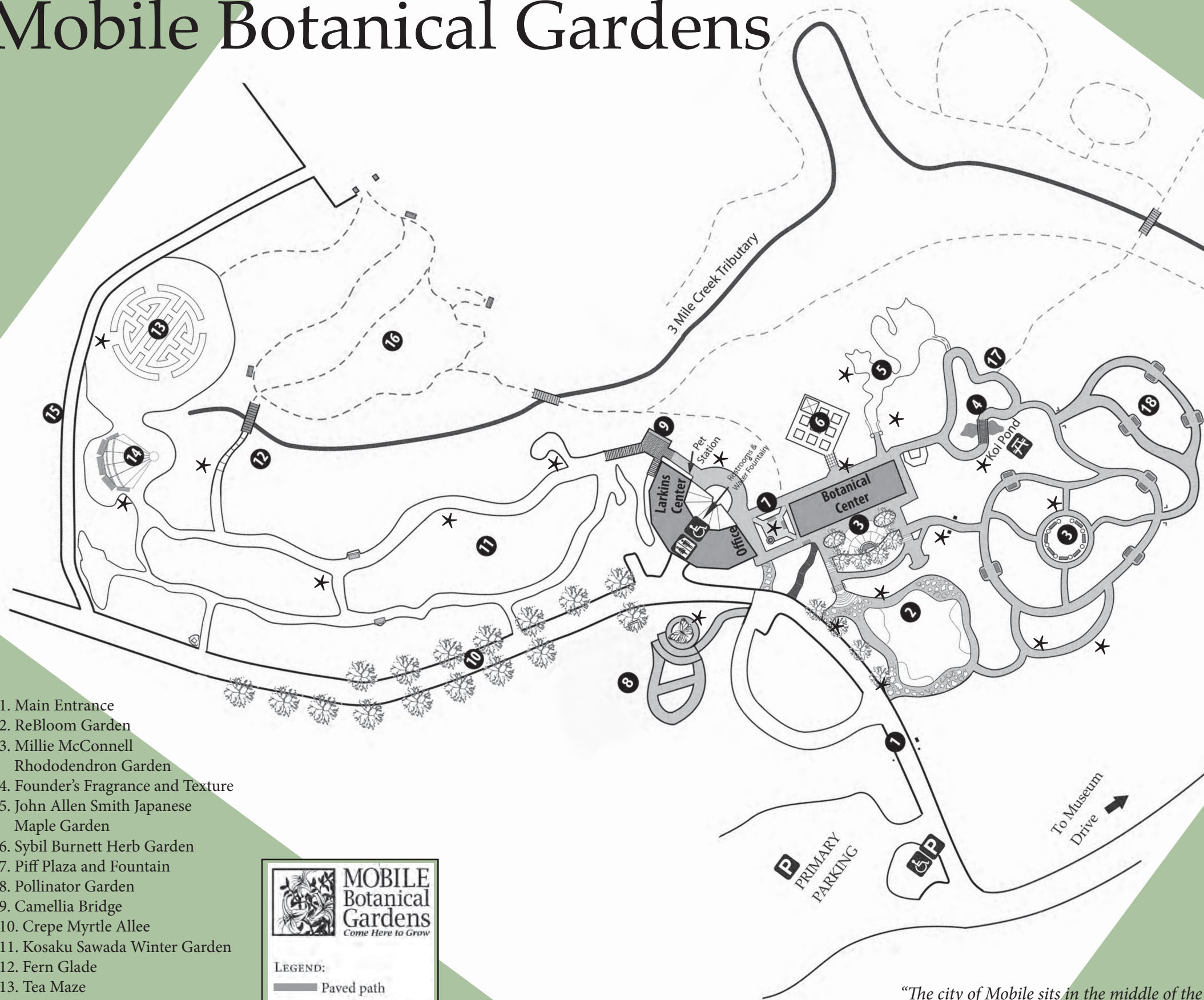

1. Main Entrance
2. ReBloom Garden
3. Millie McConnell Rhododendron Garden
4. Founder's Fragrance and Texture
5. John Allen Smith Japanese Maple Garden
6. Sybil Burnett Herb Garden
7. Piff Plaza and Fountain
8. Pollinator Garden
9. Camellia Bridge
10. Crepe Myrtle Allee
11. Kosaku Sawada Winter Garden
12. Fern Glade
13. Tea Maze
14. Dodd Quarry
15. Magnolia Grove
16. Deep Woods Trails
17. Katherine Shropshire Trails
18. Aromi Hybrid Azalea Garden

**MOBILE Botanical Gardens**  
Come Here to Grow

**LEGEND:**

- Paved path
- Unpaved path
- Trail
- Stream
- Audio Stop

*"The city of Mobile sits in the middle of the biologically richest part of North America."*  
- E.O. Wilson, Harvard University biologist and Pulitzer Prize winning author



The largest urban Longleaf forest in the state...



The largest and most significant Aromi Hybrid Azalea collection in the world... (Blooms in April)

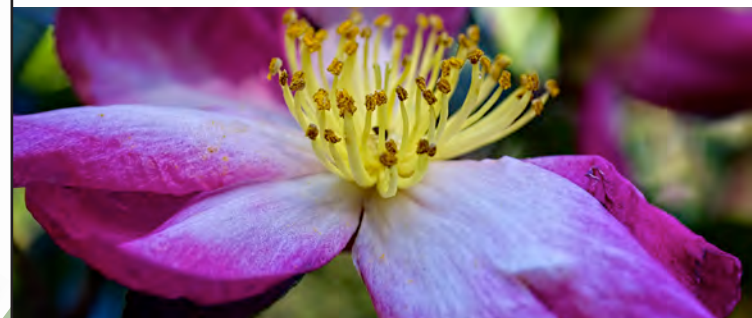

A world class camellia collection- One of only eight ICS Gardens of Excellence in the country (Blooms Oct. - Mar.)



Plant selections developed under our ReBloom program that are suited to our Gulf Coast environment

STOP Numbers are printed on the QR signs throughout the gardens, which are indicated by a ✱ on the map



Try our **onCell** Audio Tour!  
Scan QR to begin or  
Call 251.287.9761  
Visit [mbgardens.toursphere.com](http://mbgardens.toursphere.com)